

How to use your Caeli Wall™

Mount your Caeli Wall at the most convenient location. It is easy to move around and wheel into place after set up.

If necessary, adjust the wheel base for further stabilisation of the wall. And you can always do this later.

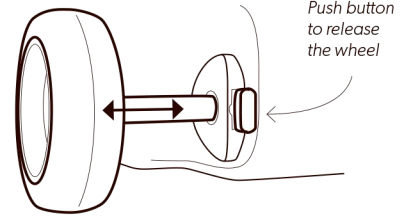

Push button to release the wheel

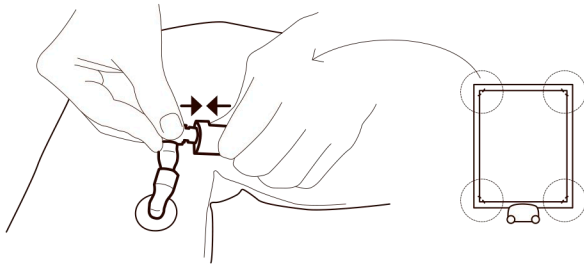

Make sure the quick connectors in the tube's corners are firmly closed with a click.

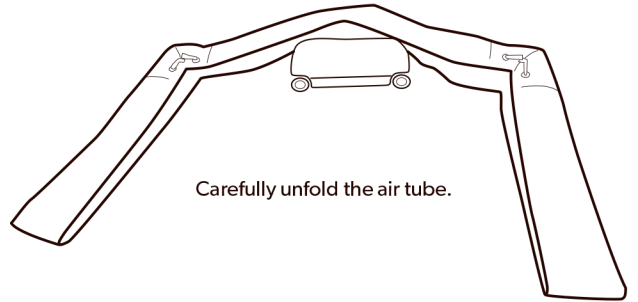

Carefully unfold the air tube.

Plug the accompanying power cord into the socket on the side of the bag and connect to mains.

The pump will start automatically.

The tube rises as it inflates, you may want to support it a little to ease the air flow.

The pump will stop automatically at the required air pressure.

It is recommended to disconnect the power cord after filling; this will give you the freedom to move Caeli Wall around and you avoid the sound of the pump refilling. Air pressure will be sufficient for a long period* and you can refill whenever necessary/convenient.

If you leave Caeli Wall connected to power, the pump will start automatically when the air pressure drops.

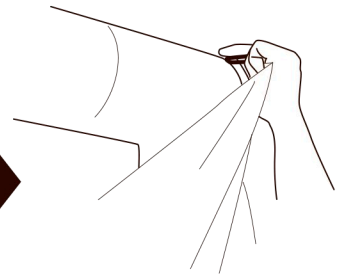

Attach your screen(s) to the 12 attachment points on the tube.

Deflate the wall by releasing the four quick connectors.

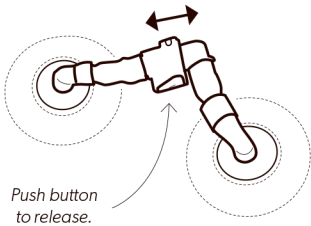

Push button to release.

If the wall slants a bit to either side, adjust the straps at the tub's bottom center by loosening or tightening respectively to balance the frame.

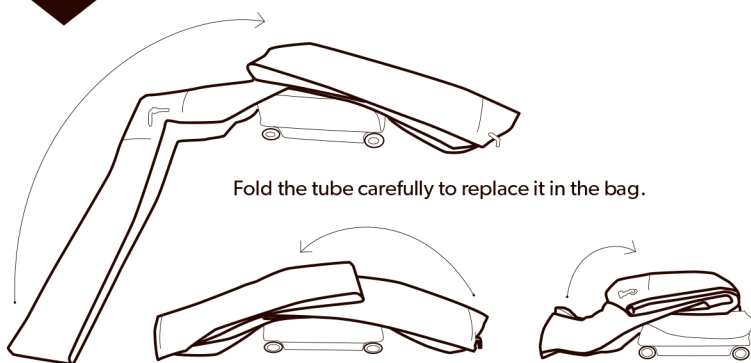
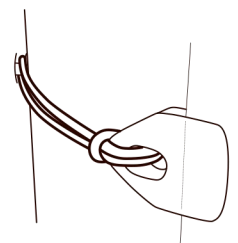
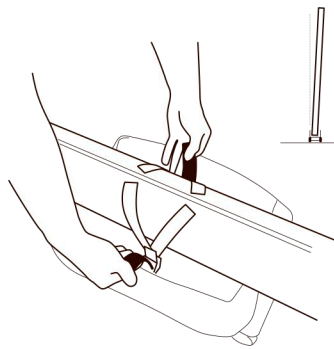

Fold the tube carefully to replace it in the bag.

Caeli Wall is now ready for transport and reuse.



For further information

www.caeliwall.com

* All products are tested for 4 hours without refilling. For prolonged use, refill as necessary or leave Caeli Wall connected to mains.